



# GS DualBrew

## QUICK INSTALLATION GUIDE



### Installation & Service Manual

Available by scanning  
this QR code.

*Images may vary from the actual product.*

## Table of Contents

<b>1</b>	<b>SAFETY INSTRUCTIONS</b>	<b>2</b>
1.1	Food-Contact Parts	2
1.2	Warnings	2
1.3	Power Supply	2
1.4	Disconnect the Equipment if:	2
<b>2</b>	<b>BREWER SPECIFICATIONS</b>	<b>3</b>
2.1	External View	3
2.2	Rear View	3
2.3	Internal View	4
2.4	Brew Group Assembly	4
2.5	Dimensions and Clearances	5
2.6	Technical Specifications	5
<b>3</b>	<b>INITIAL SETUP</b>	<b>5</b>
3.1	On-Site Installation Requirements	5
3.2	Chute Hole Cutting (Optional)	6
3.3	Unpacking	7
3.4	Leveling the Equipment	7
3.5	Drip Tray Installation	8
3.6	Water Line Connection	8
3.7	Electrical Connection	9
3.8	Loading Products	9
3.9	Chute Hole Hiding Plate Installation	10
3.10	Chute Kit Installation (Optional)	10
3.11	Installation Verification	10
3.12	Service Menu On-Screen Assistance	10

**GAGGIA**  
MILANO

Manufactured by:  
Evoca North America Venture Inc.  
Tel.: 800-561-6162 Fax: 800-463-2739  
service.na@evocagroup.com www.evocagroupna.com

25DOC06A - Rev. 0 / 2025-12



This symbol is used to highlight a key step to anticipate a risk for safety or a risk of damaging the equipment.



This symbol is used to indicate additional information or a quick tip.

# 1 SAFETY INSTRUCTIONS

Basic safety precautions should always be followed when using electrical appliances.  
Read all instructions before using this brewing equipment.

## 1.1 Food-Contact Parts

Evoca recommends cleaning and sanitizing all parts in contact with food prior to installation and use.

## 1.2 Warnings

To minimize the risk of fire or electric shock, do not expose this equipment to rain or moisture.  
Do not immerse this equipment in water; it could lead to electric shock or other malfunctions.  
Do not use this equipment other than for its intended use.  
This equipment contains hot water. Never move it when full.  
This brewing equipment is intended for indoor use only.

## 1.3 Power Supply

Always use a grounded 208 to 240 VAC 60 Hz socket outlet rated for 15A service.  
Each brewing equipment must have its own electrical outlet, on a dedicated circuit.  
Extension cords must not be used.  
This brewer is equipped with a polarized alternating current line plug (one blade wider than the other).  
Only use this plug with an outlet in which the prongs can be fully inserted.

## 1.4 Disconnect the Equipment if:

- Damage is done to the power cord.
- The equipment does not work properly.
- The temperature of the power cord or plug increases dramatically during use.
- Unusual conditions occur.
- Whenever a part has to be changed, plugged or unplugged.



**FAILURE TO COMPLY CAN CAUSE EQUIPMENT DAMAGE, FIRE OR SERIOUS INJURIES.**

## 2 BREWER SPECIFICATIONS

### 2.1 External View

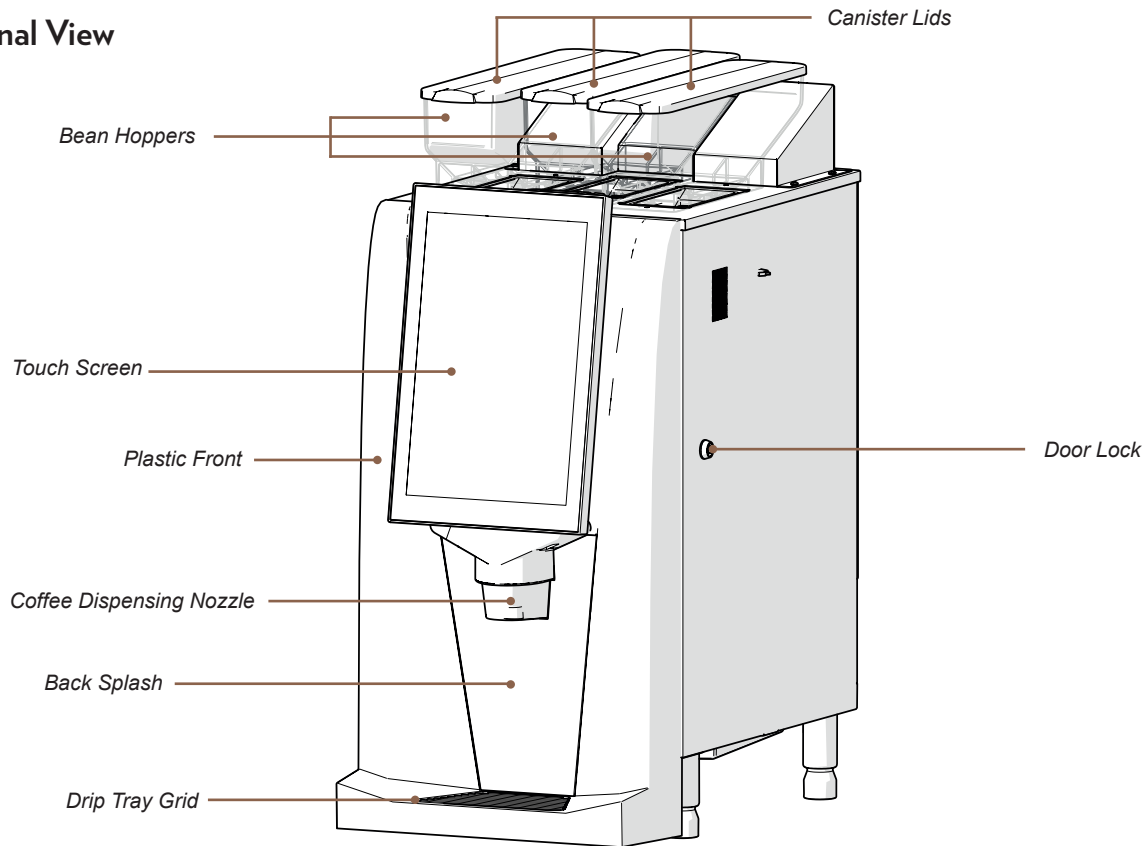

### 2.2 Rear View

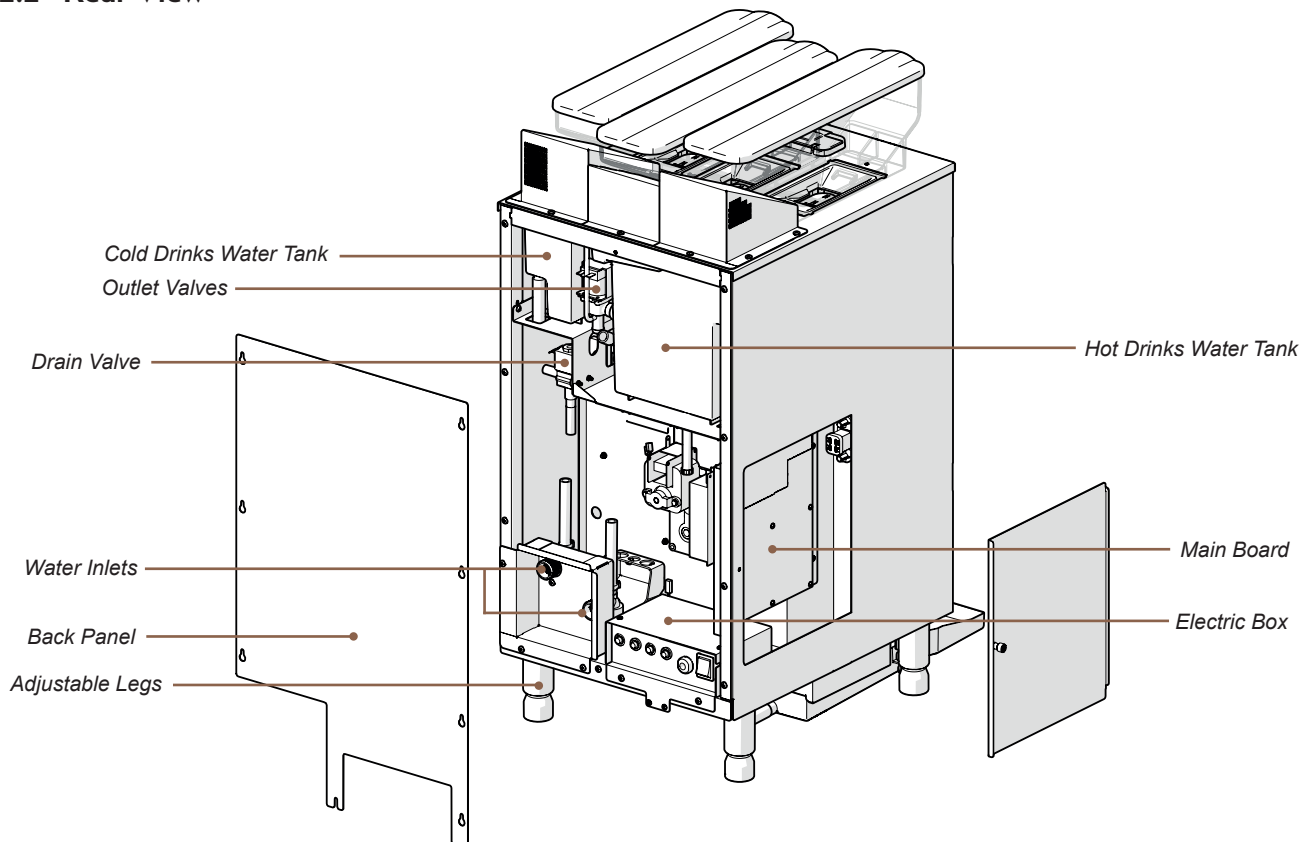

## 2.3 Internal View

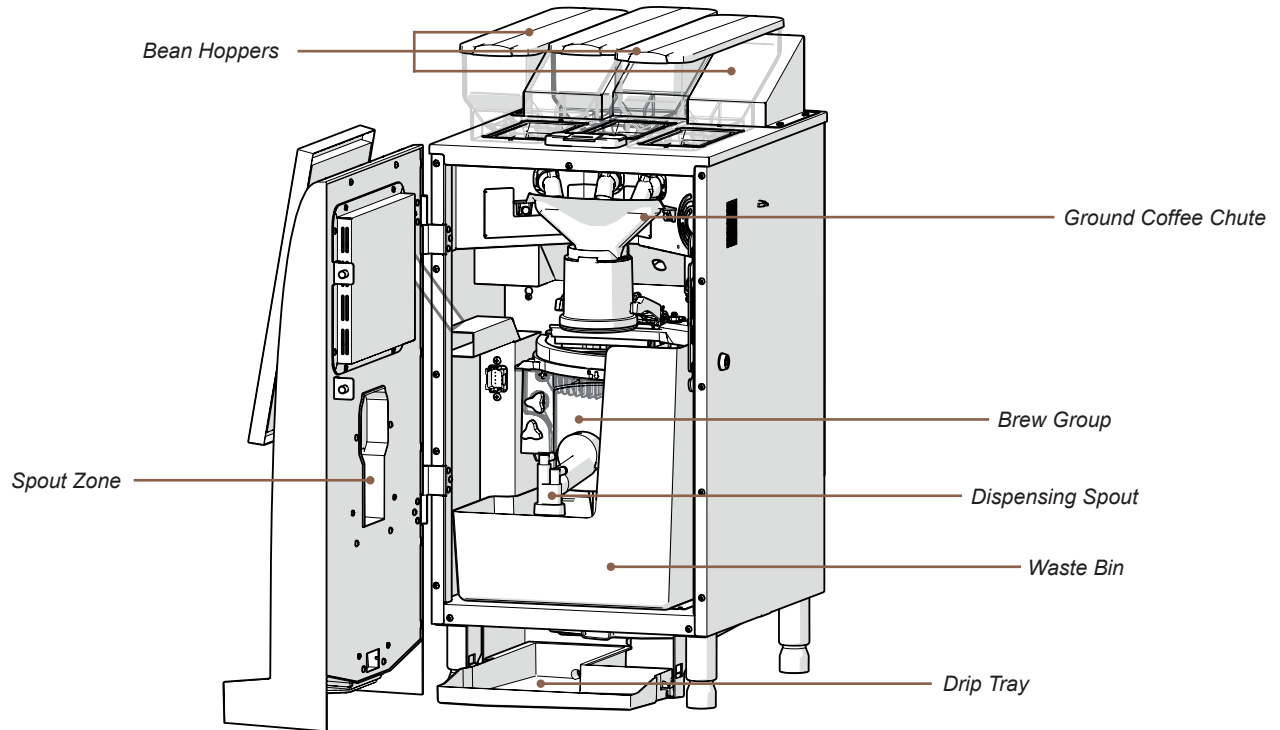

## 2.4 Brew Group Assembly

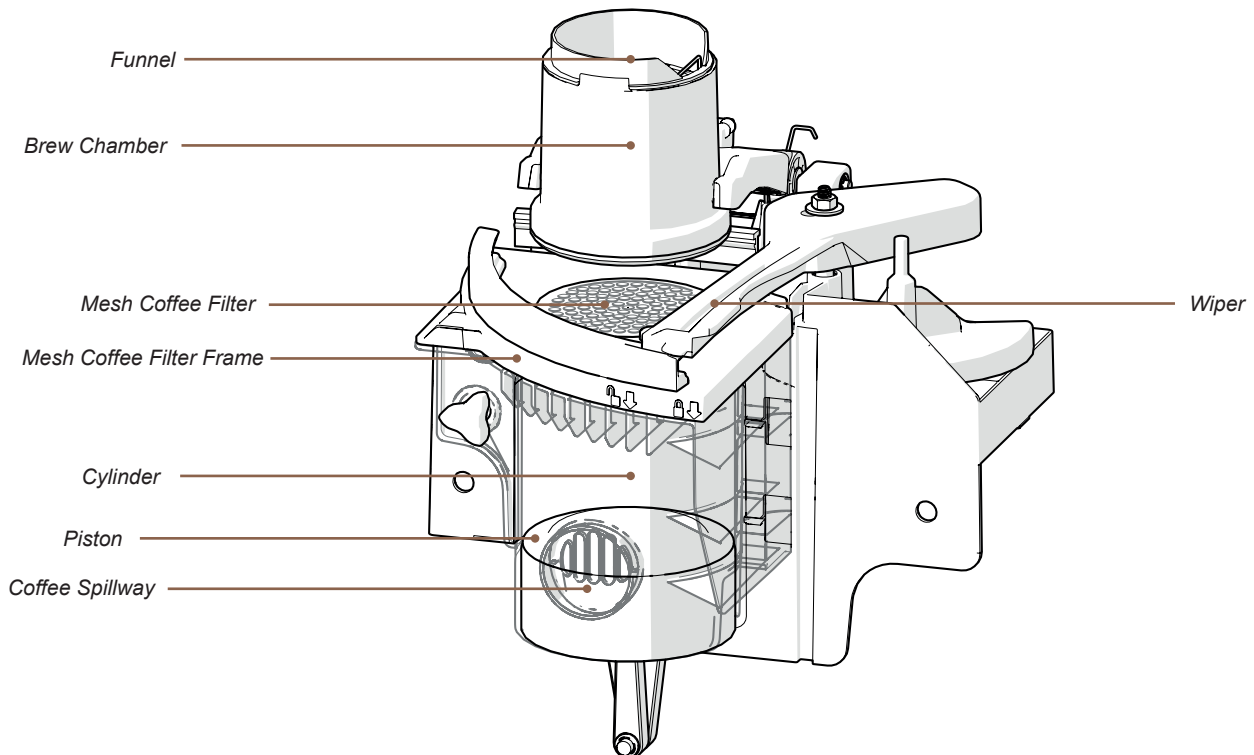

Crush hazard. Handle the brew group cautiously.

## 2.5 Dimensions and Clearances

	Unit	Clearances	Allowance for
Height	34.25"	40.25"	Opening top lid.
Width	15.29"	16.29"	Accessing lock (right side) and opening door (left side).
Depth	24.50"	30"	Minimum countertop depth.
Back Clearance	—	1.75"	Clearance for water hookup, hoses and adequate air circulation.

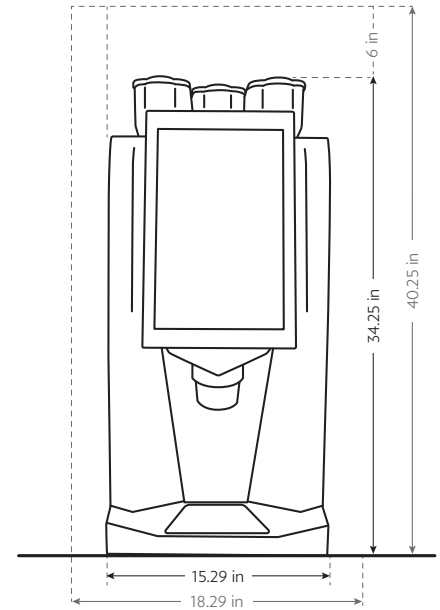

## 2.6 Technical Specifications

### 2.6.1 Hopper & Canister Capacities

- Whole bean hopper, left section 2.3 lb (0.9 kg)
- Whole bean hopper, middle section 2.3 lb (0.9 kg)
- Whole bean hopper, right section 2.3 lb (0.9 kg)

### 2.6.2 Water Tank

- Capacity Hot: 0.74 gallon (2.8 L)  
Cold: 0.26 gallon (1.1 L)
- Water valves 4 simple valves
- Heating element Hot: 2500 watts  
Cold: 500 watts

### 2.6.3 Electrical Specifications

208-240 VAC / 60 Hz - 13 A

### 2.6.4 Weight

120 lb (54.43 kg)

# 3 INITIAL SETUP

Before installing the brewer at the desired location, it is strongly suggested to unpack, inspect and perform a bench test of the machine at the warehouse.

## 3.1 On-Site Installation Requirements

### 3.1.1 Operating Environment

Equipment is for indoor use only.

### 3.1.2 Power Supply

Make sure each unit has its own electrical circuit and is located within five (5) feet of the dedicated electrical outlet.  
Use only a polarized grounded receptacle.  
Domestic 208-240 VAC / 60 Hz - 13 A circuit. NEMA L6-20P plug.

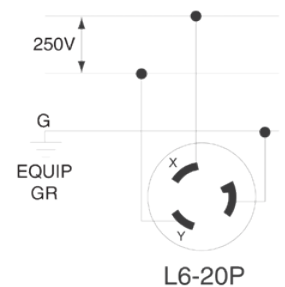

### 3.1.3 Water Supply

Use a plastic 1/4" or 3/8" (outside diameter) dedicated line branched off a larger line.

An easily accessible shut off valve upstream of the unit is highly recommended for ease of installation. Make sure that your installation complies with your federal, state, provincial and/or municipal codes.

Cold tap water pressure should be at least 20 psi and no more than 80 psi.



**Do not use distilled water.**



**The GS DualBrew is NSF/ANSI 4 certified. For your installation to comply with NSF/ANSI 4 standards, a backflow protection meeting applicable federal, state, provincial and local regulations must be installed on the water inlet.**

### 3.1.4 Tools Required

- Adjustable wrench
- Level indicator



**Other tools may be required depending on the type of water supply tubing and location.**

## 3.2 Chute Hole Cutting (optional)

If the machine needs to be installed with a chute kit, refer to the chute hole positioning plan below to cut the counter. Cut the hole in the counter top prior to installing the machine on it.

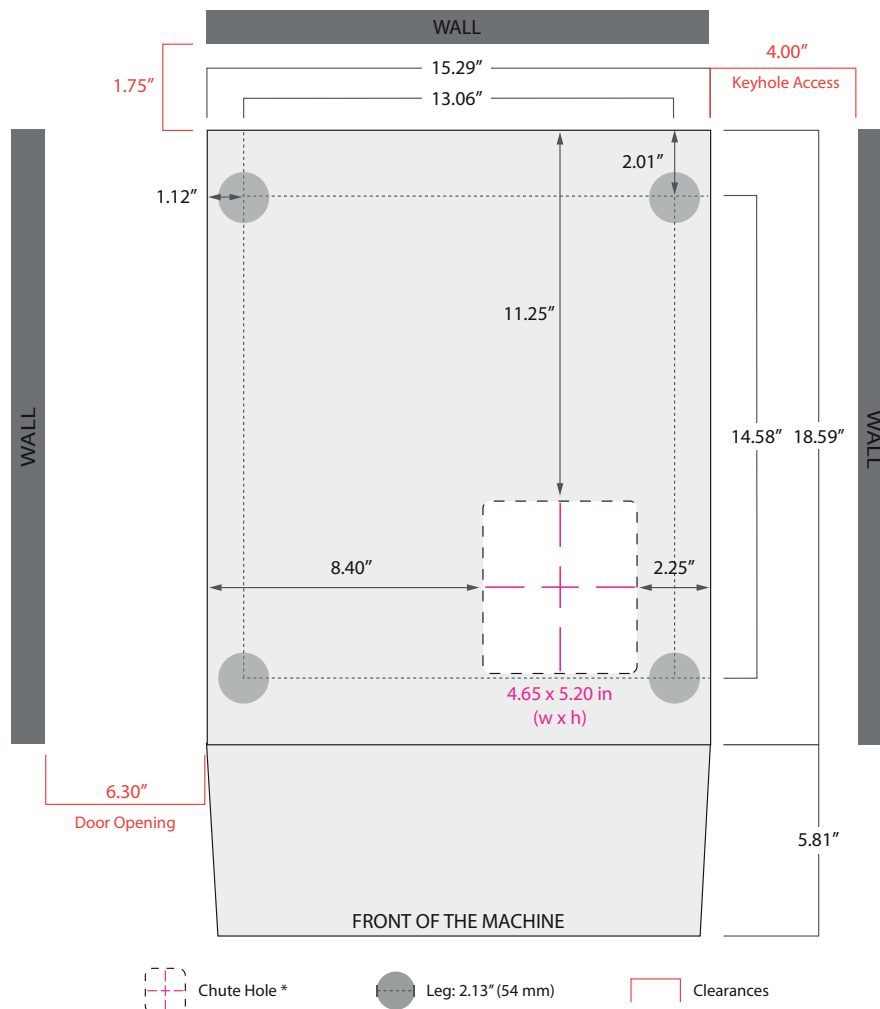

### 3.3 Unpacking

To remove the unit from the box, carefully cut the straps securing the box to the skid.

Once the straps are removed, detach the bottom layer of the packaging, open the top flaps of the box, and lift the entire box upward to free the machine.

Make sure to keep the machine stable while lifting the box to avoid any damage.

#### Parts required for installation

1. Water Inlet Kit
2. Brush
3. Thumb Nuts (4)
4. Chute Hole Hiding Plate
5. Internal Waste Bin
6. 5/8" Draining Tube
7. Drip Tray Grid
8. Drip Tray
9. Tray Overflow
10. Tube Holder

#### Other items provided

- Machine Keys (2)
- Initial Setup Instructions

#### Optional

- Plastic Chute Kit (Chute Base and Chute)

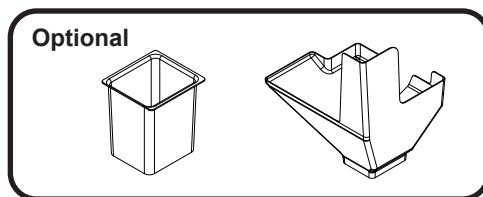
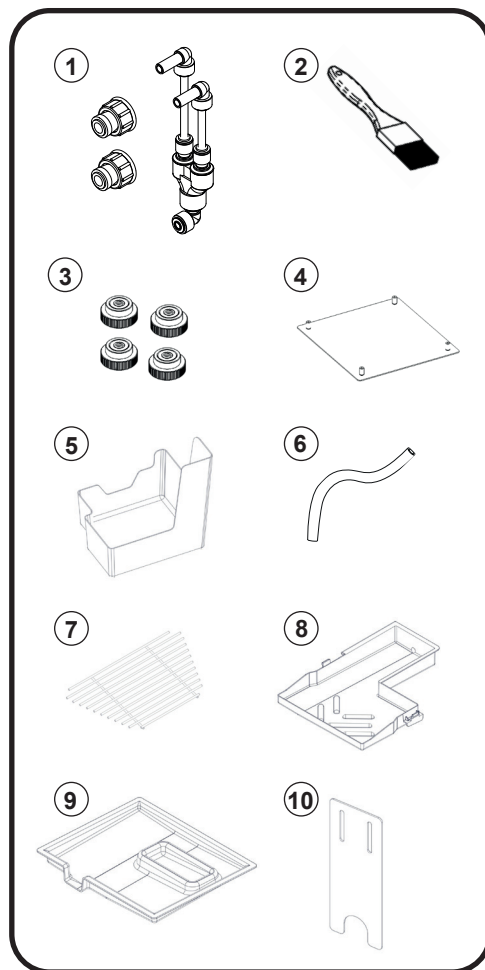

### 3.4 Leveling the Equipment

For optimal performance of the equipment, it is important to ensure that it is leveled. Avoiding to do so can create variations in product delivery.

Adjust the four (4) threaded level legs of the equipment with an adjustable wrench to reach a leveled position, horizontally and vertically.

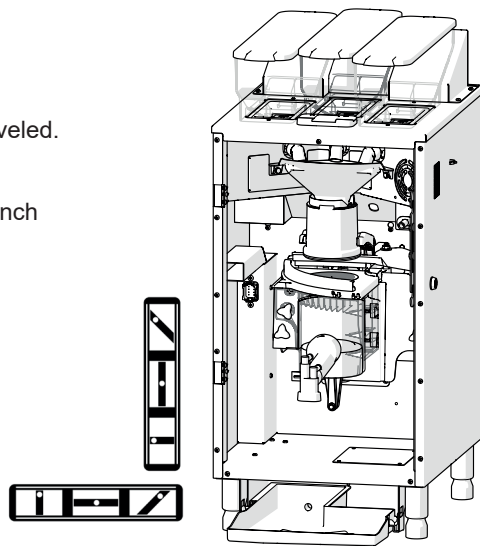

### 3.5 Drip Tray Installation

Place the drip tray grid on the bottom section of the plastic door.

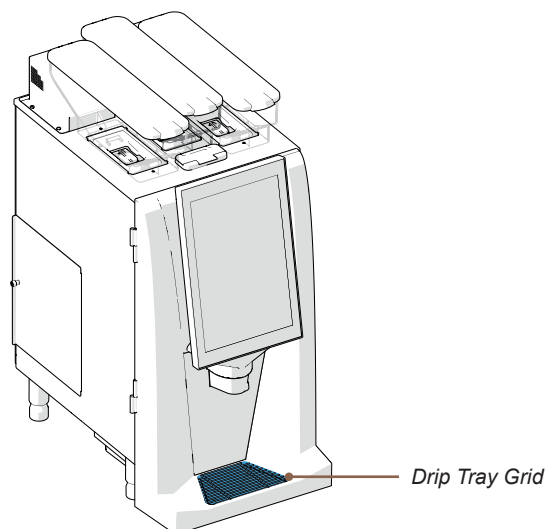

### 3.6 Water Line Connection



**This equipment must be installed in compliance with applicable federal, state, provincial and/or municipal plumbing codes having jurisdiction. Make sure that the equipment is unplugged before proceeding with the water supply installation. Also verify that the incoming water pressure is greater than 20 psi and no more than 80 psi.**



**Do not use distilled water.**

1. Prior to installing the equipment, flush out the water line by running approximately 1 gallon of water into a pail. This will ensure no sediment from a new installation gets in the equipment.
2. The incoming water supply must have a shut-off valve connected in-line. Water supply should be a plastic 1/4" or 3/8" outside diameter dedicated line branched off a larger supply line.
3. Make sure the water source is turned off. Firmly secure the inlet fitting onto the inlet valve. Do not overtighten.
4. Make sure the equipment is unplugged. Connect the water line to the quick connect inlet fitting.
5. Turn the water valve on, sending water to the brewer. If there are any leaks, tighten connections to stop leakage.



**This procedure does not take into consideration the installation of a water filtration system. Please refer to the water filter manufacturer's installation instructions and incorporate them with the above procedures.**

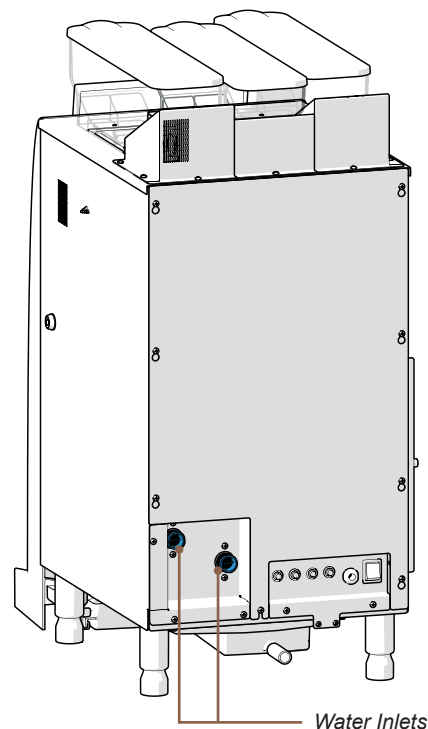



### 3.7 Electrical Connection

This equipment must be installed in compliance with applicable federal, state, provincial and/or municipal electrical codes having jurisdiction.

Make sure:

- The equipment is OFF before plugging it in.
- The equipment has its own electrical outlet.
- NO extension cord is used.

1. Locate the unit's power cord.
2. Make sure the power switch at the back of the unit is in the OFF position before plugging it into its own grounded electrical outlet.
3. Toggle the power switch to the ON position. The front lights will turn on, and water will automatically enter the machine to fill the tank. The water tank filling process should take a maximum of three (3) minutes.
4. Once the tank is full, water will take 10-20 minutes to heat to brewing temperature.
5. Once the coffee machine is ready, the selection screen will appear.

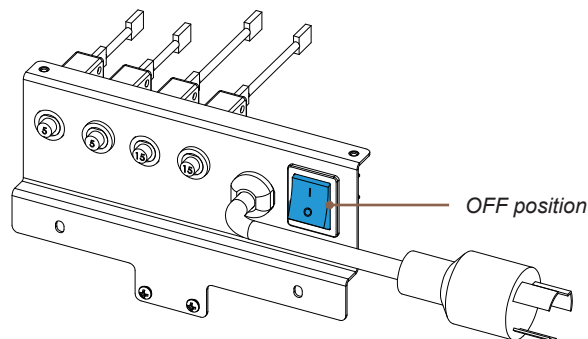

**ALWAYS** unplug the main power cord from the outlet (AC voltage) when servicing

### 3.8 Loading Products

1. Remove the lids.
2. Fill the compartments with their appropriate coffee blend.  
**Do not overfill the bean hopper.**
3. Reinstall the lids.

3 Bean hoppers



**Caution!** Flavored coffee beans can contain ethyl alcohol that could affect the bean hopper's longevity. Evoca do not recommend using flavored beans.

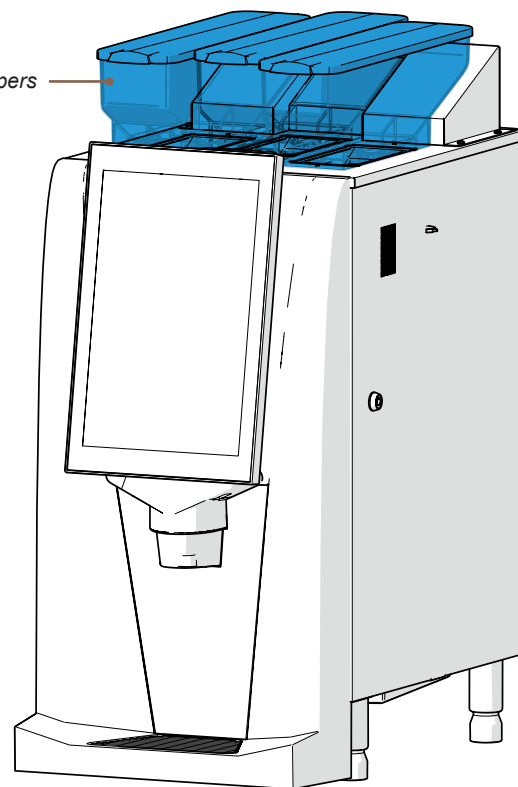

### 3.9 Chute Hole Hiding Plate Installation

1. Open the brewer's door and remove the internal waste bin.
2. Insert the chute hole hiding plate in the chute hole of the cabinet.
3. Use the 4 thumb nuts to fix the plate under the brewer.

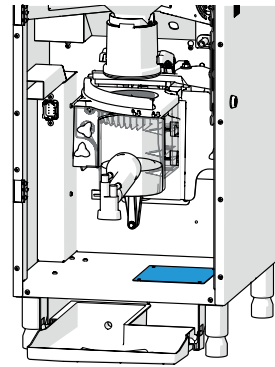

### 3.10 Chute Kit Installation (Optional)

1. Open the brewer's door and remove the internal waste bin.
2. Remove and discard the chute hole hiding plate (if installed).
3. Insert the chute base inside the chute hole of the cabinet.  
Make sure the shortest side points to the back of the machine.
4. Insert the waste chute into the chute base.

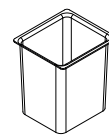

Chute Base

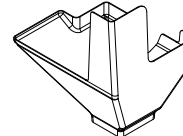

Waste Chute

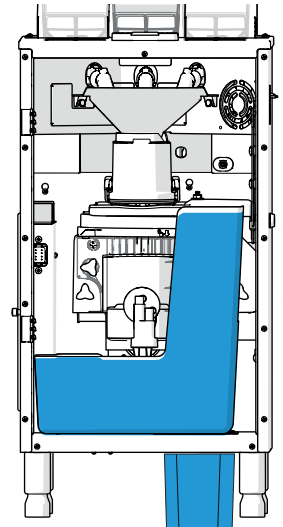

### 3.11 Installation Verification

It is important to perform several brew cycles on the equipment before completing the installation. At least two (2) cups of each product selection should be ordered to ensure that the brewer is operating as per the specifications laid out in this manual. During this process, review the following checklist as a reminder. Make sure that the brewer is clean, safe and functioning once it is ready to be left on-site.

#### What to verify

<input checked="" type="checkbox"/>	Inlet valve is free of leaks.	Verify that it is secured and not overtightened.
<input checked="" type="checkbox"/>	Brew chamber is empty of coffee.	Verify that the unit is leveled.
<input checked="" type="checkbox"/>	Water temperature is acceptable.	Verify water temperature.
<input checked="" type="checkbox"/>	Products are loaded.	Load products.
<input checked="" type="checkbox"/>	Brewer and area are clean and tidy.	Clean and tidy up.

### 3.12 Service Menu On-Screen Assistance

On-screen information and guidance are available throughout the Service Menu.

To access those instructions, press the blue question mark located in the top-left corner of the screen. Once enabled, select the question mark next to any feature to view additional details and instructions.

